

Cautions

- Ensure you fill in the Date Fitted Box (8) to allow you to monitor how long the Libra Leg Bag has been in use. Change the Leg Bag every 5-7 days
- The Libra Leg Bag should not be reused after disconnection from a catheter due to increased risk of infection
- Keep out of the reach of children
- Use of any medical device carries associated risks. Device failures are rare, however in the event of a device failure of this product, you should contact Great Bear Healthcare using the details provided within this leaflet
- If a failure has resulted in a serious incident, such as significant deterioration of health or death, you should contact Great Bear Healthcare and your local Competent Authority as soon as possible. Details of your local Competent Authority can be found on your local government website

Order Codes

Libra Leg Bag – Prescription			
Code	Capacity	Tube Length	Qty
10130G	350ml	Direct Inlet	10
10131H	500ml	Direct Inlet	10
10132J	750ml	Direct Inlet	10
10133K	1000ml	Direct Inlet	10
10100A	350ml	Short (10cm)	10
10102C	500ml	Short (10cm)	10
10106G	750ml	Short (10cm)	10
10104E	500ml	Long (30cm)	10
10108J	750ml	Long (30cm)	10
10120W	1000ml	Long (30cm)	10
10105F	500ml	Adjustable (45cm)	10
10110L	750ml	Adjustable (45cm)	10
10122Y	1000ml	Adjustable (45cm)	10

Libra Leg Bag – Hospital			
Code	Capacity	Tube Length	Qty
10230C	350ml	Direct Inlet	10
10200W	350ml	Short (10cm)	10
10202Y	500ml	Short (10cm)	10
10206C	750ml	Short (10cm)	10
10204A	500ml	Long (30cm)	10
10208E	750ml	Long (30cm)	10
10205B	500ml	Adjustable (45cm)	10
10210G	750ml	Adjustable (45cm)	10



Products available through Nightingale Home Delivery Service

1. Call **Freephone 0800 304 7434**
2. Please ensure you have your GP details to hand.
3. Tell us which products are required and how many.

That's all – we will do everything else!

Please make sure you have at least two week's supply in hand before re-ordering.



Libra[®] Leg Bag

Instructions For Use



Great Bear Healthcare Ltd
1 Lambourne Crescent,
Cardiff Business Park,
Cardiff, CF14 5GF
T +44 (0) 29 2074 7770

EC REP
MediReps Ltd
First Floor, Penrose One,
Penrose Dock, Cork City,
T23 KW81,
Ireland

mail@gbhl.co.uk
www.greatbearhealthcare.co.uk

LIBRAFU7/2022

 A UK manufacturer committed to Urology.

Your Libra® Leg Bag

Libra Leg Bags are for the daytime storage and drainage of urine.

Designed to be connected directly to a catheter or sheath for continuous drainage.

Libra Leg Bags can also be connected to a Night Bag for overnight drainage (page 3).

Libra Leg Bags should be changed every 5-7 days.

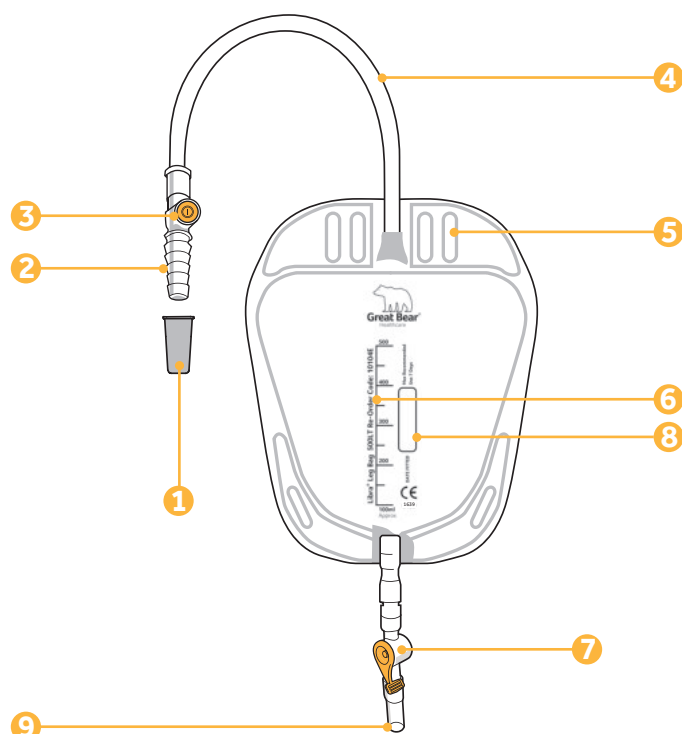

Key	
1 Protective Cap	6 Graduated Scale*
2 Ridged Inlet Connector	7 Outlet Tap
3 Needle Free Sample Port	8 Date Fitted Box
4 Inlet Tube	9 Silicone Sleeve
5 Eyelets	

* The graduated scale is an approximation and should not be used for accurate measurement of urine output

Instructions For Use

Before Use

- 1) Wash Hands
- 2) Open peel pouch and remove Libra Leg Bag from its packaging
- 3) Ensure the lever on the outlet tap (7) is in the closed position (Diagram 1)
- 4) Remove the grey protective cap (1) from the Libra inlet connector (2)

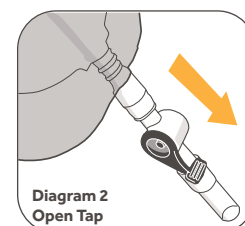
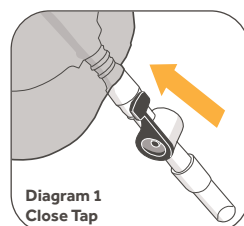

Direct Connection

- 1) Insert the ridged inlet connector (2) into the end of the Indwelling Catheter or Sheath. Insert the connector fully to allow a secure connection.
- 2) The Libra Leg Bag should be positioned on the thigh or calf, depending on the tube length, and secured appropriately with the leg bag straps provided.
- 3) Feed the Libra Leg Bag Straps through the eyelets (5) on the bag and ensure the wavy silicone lines face onto the leg.
- 4) Make sure the inlet tubing (4) isn't kinked which can restrict the flow of urine.

Emptying

- 1) Empty the Libra Leg Bag by pushing the lever on the outlet tap (7) downwards (Diagram 2).
- 2) After emptying, wrap the outlet tap with a tissue and pat a number of times before gently wiping around the inside of the valve. This will dislodge any residual urine.
- 3) Remember to close the tap after emptying (Diagram 1).

- 4) The outlet tap (7) can be twisted to avoid accidental emptying.

Overnight Drainage

If you require additional drainage for overnight use, a night bag can be connected as part of an overnight link system.

- 1) When you go to bed, do not disconnect your Libra Leg Bag from your Catheter or Sheath.
- 2) Insert the connector of your Night Bag to the silicone sleeve (9) on your Libra Leg Bag. Insert the connector fully to allow a secure connection.
- 3) Once connected, turn the Libra Leg Bag tap to the open position (Diagram 2) to allow the overnight drainage into the Night Bag.
- 4) Before disconnecting the Night Bag in the morning, ensure the Libra Leg Bag tap is in the closed position (Diagram 1).

Libra Leg Bags with adjustable tubing

Adjustable Libra Leg Bags have a 45cm tube (4). If connecting directly to a Sheath, these can be cut to the desired length and fitted with the spare connector included in the pouch.

- 1) Place the Libra Leg Bag on your leg in the desired position and secure as instructed on page 2.
- 2) Measure how long you need the tubing and cut to the desired length.
- 3) Remove the Libra Leg Bag from your leg and insert the spare connector into the inlet tube.
- 4) Connect the Libra Leg Bag as per the instructions on page 2.

Caution: Do not cut the tube length yourself if you are connecting to an Indwelling Catheter as the sterility of the product may become compromised. Please contact our helpline on 0800 055 6270 for further advice.

Storage and Disposal

- 1) The Libra Leg Bag should be stored at an ambient temperature and allowed to come to room temperature before use.
- 2) Dispose with normal household waste – do not flush down the toilet.